

# LUCERNE LAKES GOLF COURSE A PORTION OF LUCERNE LAKES P.U.D.

LYING IN SECTIONS 28 AND 33, TOWNSHIP 44 SOUTH, RANGE 42 EAST, PALM BEACH COUNTY, FLORIDA, BEING  
A REPLAT OF A PORTION OF TRACTS 1, 2, 30 THROUGH 38, 58 THROUGH 71, 90 THROUGH 95, 98 THROUGH 103, AND 122 THROUGH 127,  
BLOCK 29, PALM BEACH FARMS Co. PLAT No.3 RECORDED IN PLAT BOOK 2, PAGE 45 OF THE PUBLIC RECORDS OF PALM BEACH COUNTY

JANUARY 1999

SHEET 1 OF 6

COUNTY OF PALM BEACH )  
STATE OF FLORIDA )  
This Plat was filed for record at 9:11 a.m. on the 17 day of April, 1999, and duly recorded in Plat Book No. 27 on page 184-189.  
DOROTHY H. WILKINSON, Clerk of Circuit Court  
by *[Signature]* D.C.

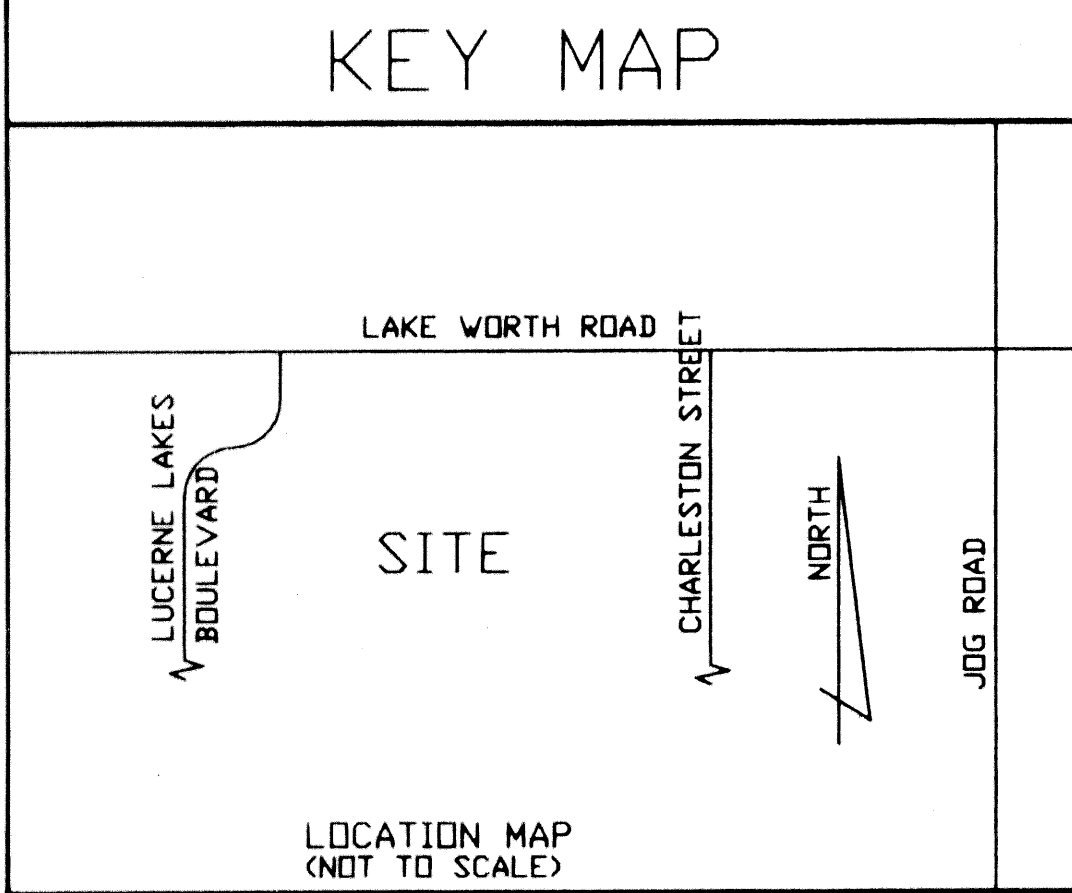
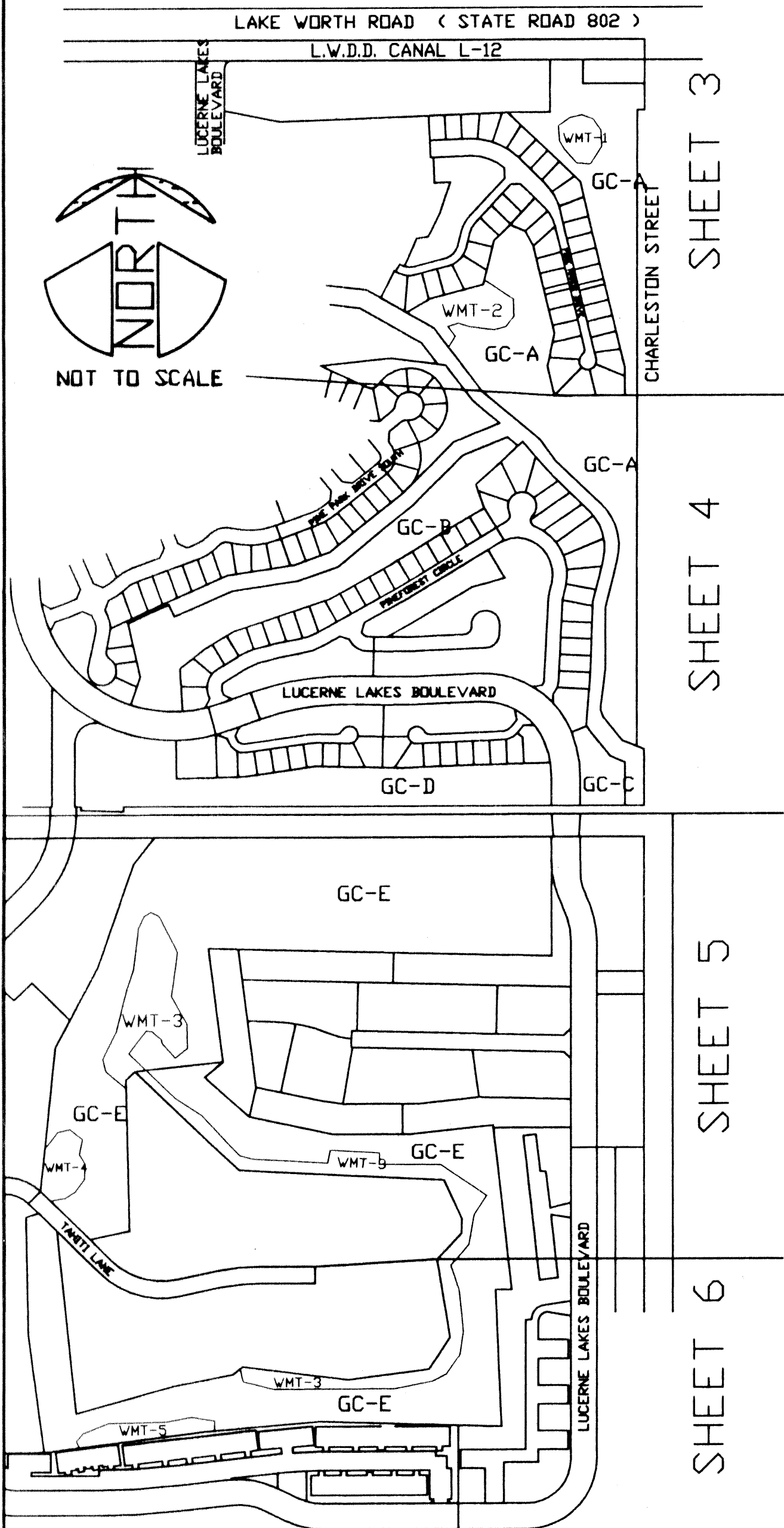

**DEDICATION AND RESERVATION:**  
KNOW ALL MEN BY THESE PRESENTS THAT FLORIDA GARDENS LAND DEVELOPMENT COMPANY, A FLORIDA CORPORATION, OWNER OF THE LAND SHOWN HEREON, BEING IN SECTIONS 28 AND 33, TOWNSHIP 44 SOUTH, RANGE 42 EAST, PALM BEACH COUNTY, FLORIDA, BEING A REPLAT OF A PORTION OF TRACTS 1, 2, 30 THROUGH 38, 58 THROUGH 71, 90 THROUGH 95, 98 THROUGH 103, AND 122 THROUGH 127, BLOCK 29, PALM BEACH FARMS Co. PLAT No.3, RECORDED IN PLAT BOOK 2, PAGE 45 OF THE PUBLIC RECORDS OF PALM BEACH COUNTY, FLORIDA, SHOWN HEREON AS:  
LUCERNE LAKES GOLF COURSE  
BEING MORE PARTICULARLY DESCRIBED AS FOLLOWS:

**LEGAL DESCRIPTION - GC-A**  
A PARCEL OF LAND IN SECTION 28, TOWNSHIP 44 SOUTH, RANGE 42 EAST, BEING A PORTION OF TRACTS 1, 2, 30 THROUGH 34, AND 64, BLOCK 29, OF PALM BEACH FARMS CO. PLAT NO.3, RECORDED IN PLAT BOOK 2, PAGE 45, OF THE PUBLIC RECORDS OF PALM BEACH COUNTY, FLORIDA, MORE PARTICULARLY DESCRIBED AS FOLLOWS:  
BEGIN AT THE NORTHEAST CORNER OF PLAT NO.1, LUCERNE LAKES (PUD), RECORDED IN PLAT BOOK 30, PAGE 41 OF SAID PUBLIC RECORDS, LYING ON THE SOUTH RIGHT-OF-WAY OF LAKE WORTH DRAINAGE DISTRICT CANAL L-12 AS SHOWN ON SAID PLAT; THENCE ALONG SAID SOUTH RIGHT-OF-WAY, N90°00'00"E FOR 115.00 FEET;

THENCE DEPARTING SAID SOUTH RIGHT-OF-WAY, S00°00'00"W FOR 83.00 FEET;  
THENCE S89°59'56"E FOR 215.00 FEET TO THE WEST RIGHT-OF-WAY OF CHARLESTON STREET, A 50' RIGHT-OF-WAY, PER SAID PALM BEACH FARMS CO. PLAT NO.3; THENCE ALONG SAID WEST RIGHT-OF-WAY, S00°00'00"W FOR 87.00 FEET TO THE WEST RIGHT-OF-WAY OF CHARLESTON STREET PER AN ORDER OF TAKING RECORDED IN OFFICIAL RECORD BOOK 4179, PAGE 1199 OF SAID PUBLIC RECORDS;

THENCE ALONG SAID WEST RIGHT-OF-WAY FOR THE FOLLOWING COURSES:  
THENCE N89°59'56"E FOR 25.00 FEET;  
THENCE S00°00'00"W FOR 2226.91 FEET TO THE BOUNDARY OF PLAT NO.2, LUCERNE LAKES (PUD) RECORDED IN PLAT BOOK 32, PAGE 191 OF SAID PUBLIC RECORDS;

THENCE ALONG SAID PLAT BOUNDARY FOR THE FOLLOWING COURSES:  
THENCE N68°11'55"W FOR 55.56 FEET;  
THENCE N39°14'15"W FOR 95.96 FEET TO THE POINT OF CURVATURE OF A CURVE CONCAVE TO THE EAST, HAVING A RADIUS OF 63.50 FEET;  
THENCE NORTHERLY, ALONG SAID CURVE TO THE RIGHT, THROUGH A CENTRAL ANGLE OF 46°14'20" FOR 51.25 FEET TO A POINT OF TANGENCY;  
THENCE N07°00'05"E FOR 128.16 FEET;  
THENCE N00°00'00"E FOR 216.06 FEET;  
THENCE N4°11'37"E FOR 167.49 FEET TO THE POINT OF CURVATURE OF A CURVE CONCAVE TO THE WEST, HAVING A RADIUS OF 206.50 FEET;  
THENCE NORTHERLY, ALONG SAID CURVE TO THE LEFT, THROUGH A CENTRAL ANGLE OF 59°42'02" FOR 215.17 FEET TO A POINT OF TANGENCY;  
THENCE N45°30'25"W FOR 223.79 FEET;  
THENCE N35°36'39"W FOR 92.83 FEET;  
THENCE N49°55'00"W FOR 264.59 FEET;  
THENCE N37°01'49"W FOR 277.68 FEET;  
THENCE N60°26'08"W FOR 110.56 FEET TO THE BOUNDARY OF THE PLAT OF LUCERNE LAKES HOMES, VILLAGE II, THIRD ADDITION, RECORDED IN PLAT BOOK 37, PAGE 190 OF SAID PUBLIC RECORDS;

THENCE ALONG SAID PLAT BOUNDARY FOR THE FOLLOWING COURSES:  
THENCE N60°22'53"E FOR 95.43 FEET;  
THENCE N75°10'19"E FOR 191.47 FEET;  
THENCE N13°15'00"E FOR 160.00 FEET;  
THENCE N46°30'00"E FOR 77.00 FEET;  
THENCE S68°01'58"E FOR 58.02 FEET;  
THENCE S28°10'24"E FOR 58.60 FEET;  
THENCE S13°30'00"E FOR 316.00 FEET;  
THENCE S12°00'00"W FOR 117.00 FEET;  
THENCE S13°30'00"E FOR 105.60 FEET;  
THENCE N89°50'22"E FOR 244.65 FEET;  
THENCE N00°09'38"W FOR 96.74 FEET;  
THENCE N13°30'00"W FOR 662.67 FEET;  
THENCE N46°10'20"W FOR 352.62 FEET TO THE BOUNDARY OF SAID PLAT NO.1, LUCERNE LAKES (PUD);

THENCE ALONG SAID PLAT BOUNDARY FOR THE FOLLOWING COURSES:  
THENCE N87°52'00"E FOR 12.00 FEET;  
THENCE N90°00'00"E FOR 136.00 FEET;  
THENCE N00°00'00"E FOR 178.00 FEET TO THE POINT OF BEGINNING.  
CONTAINING 13.163 ACRES, MORE OR LESS.

**LEGAL DESCRIPTION - GC-B**  
A PARCEL OF LAND IN SECTION 28, TOWNSHIP 44 SOUTH, RANGE 42 EAST, BEING A PORTION OF TRACTS 34 THROUGH 38, AND 59 THROUGH 61, BLOCK 29, OF PALM BEACH FARMS CO. PLAT NO.3, RECORDED IN PLAT BOOK 2, PAGE 45, OF THE PUBLIC RECORDS OF PALM BEACH COUNTY, FLORIDA, MORE PARTICULARLY DESCRIBED AS FOLLOWS:  
BEGIN AT THE SOUTHWEST CORNER OF TRACT 'C' OF THE PLAT OF LUCERNE LAKES HOMES, VILLAGE I, 4TH ADDITION, RECORDED IN PLAT BOOK 34, PAGE 151 OF SAID PUBLIC RECORDS;

THENCE ALONG THE BOUNDARY OF SAID PLAT FOR THE FOLLOWING COURSES:  
THENCE N03°54'11"W FOR 151.70 FEET;  
THENCE N52°38'52"E FOR 110.08 FEET;  
THENCE N58°43'20"E FOR 116.60 FEET;  
THENCE N71°07'56"E FOR 178.01 FEET;  
THENCE N70°58'35"E FOR 176.98 FEET;  
THENCE N60°40'50"E FOR 245.44 FEET;  
THENCE N58°59'26"E FOR 377.79 FEET TO THE BOUNDARY OF THE PLAT OF LUCERNE LAKES HOMES, VILLAGE I, 5TH ADDITION, RECORDED IN PLAT BOOK 34, PAGE 167 OF SAID PUBLIC RECORDS;

THENCE ALONG THE BOUNDARY OF SAID PLAT FOR THE FOLLOWING COURSES:  
THENCE N19°15'32"W FOR 89.37 FEET;  
THENCE N46°49'26"E FOR 201.06 FEET TO THE BOUNDARY OF PLAT NO.2, LUCERNE LAKES (PUD) RECORDED IN PLAT BOOK 32, PAGE 191 OF SAID PUBLIC RECORDS;

THENCE ALONG SAID PLAT BOUNDARY FOR THE FOLLOWING COURSES:  
THENCE N49°55'00"W FOR 48.68 FEET;  
THENCE S67°38'17"W FOR 167.56 FEET;  
THENCE S44°12'55"W FOR 249.59 FEET;  
THENCE S50°38'54"W FOR 336.42 FEET;  
THENCE S70°37'49"W FOR 150.97 FEET;  
THENCE S81°25'15"W FOR 229.84 FEET;  
THENCE S66°07'58"W FOR 220.67 FEET;  
THENCE N23°52'02"W FOR 46.00 FEET;  
THENCE S65°17'06"W FOR 156.74 FEET TO THE BOUNDARY OF THE PLAT OF LUCERNE LAKES HOMES, VILLAGE I, 3RD ADDITION, RECORDED IN PLAT BOOK 33, PAGE 182 OF SAID PUBLIC RECORDS;

THENCE ALONG SAID PLAT BOUNDARY FOR THE FOLLOWING COURSES:  
THENCE S12°53'31"E FOR 191.17 FEET TO THE BOUNDARY OF A PARCEL OF LAND REFERRED TO AS "SWIMMING POOL COMPLEX", RECORDED IN OFFICIAL RECORD BOOK 3116, PAGE 549, OF SAID PUBLIC RECORDS;

THENCE ALONG SAID BOUNDARY FOR THE FOLLOWING COURSES:  
THENCE S81°33'42"E FOR 85.25 FEET; THENCE N52°38'52"E FOR 50.00 FEET; THENCE S03°54'11"E FOR 141.55 FEET TO A POINT ON A NON-TANGENT CURVE, CONCAVE NORTHERLY, HAVING A RADIUS OF 470.00 FEET, A CENTRAL ANGLE OF 01°49'43" AND THROUGH WHICH A RADIAL LINE BEARS S02°04'28"E;

THENCE, ALONG THE ARC OF SAID CURVE, A DISTANCE OF 15.00 FEET TO THE POINT OF BEGINNING.  
CONTAINING 4.640 ACRES, MORE OR LESS.

**LEGAL DESCRIPTION - GC-C**  
A PARCEL OF LAND IN SECTION 28, TOWNSHIP 44 SOUTH, RANGE 42 EAST, BEING A PORTION OF TRACT 64, BLOCK 29, OF PALM BEACH FARMS CO. PLAT NO.3, RECORDED IN PLAT BOOK 2, PAGE 45, OF THE PUBLIC RECORDS OF PALM BEACH COUNTY, FLORIDA, MORE PARTICULARLY DESCRIBED AS FOLLOWS:  
BEGIN AT THE SOUTHEAST CORNER LOT 37 OF THE PLAT OF LUCERNE LAKES HOMES, VILLAGE I, 5TH ADDITION, RECORDED IN PLAT BOOK 34, PAGE 167 OF SAID PUBLIC RECORDS;

THENCE ALONG THE BOUNDARY OF SAID PLAT FOR THE FOLLOWING COURSES:  
THENCE S68°18'47"W FOR 55.63 FEET TO THE EAST RIGHT-OF-WAY OF LUCERNE LAKES BOULEVARD, BEING A NON-TANGENT CURVE, CONCAVE TO THE WEST, HAVING A RADIUS OF 425.00 FEET, WHERE THE RADIAL LINE BEARS S68°18'47"W;

THENCE SOUTHERLY, ALONG SAID CURVE TO THE RIGHT, THROUGH A CENTRAL ANGLE OF 21°41'13" FOR 160.87 FEET TO A POINT OF TANGENCY;  
THENCE S00°00'00"W FOR 95.45 FEET TO THE SOUTH LINE OF SAID TRACT 64;

**LEGAL DESCRIPTION - GC-C (CONTINUED)**  
THENCE ALONG SAID SOUTH LINE, N89°59'20"E FOR 156.14 FEET TO THE BOUNDARY OF PLAT NO.2, LUCERNE LAKES (PUD), RECORDED IN PLAT BOOK 32, PAGE 191 OF SAID PUBLIC RECORDS;

THENCE ALONG SAID PLAT BOUNDARY FOR THE FOLLOWING COURSES:  
THENCE N00°00'00"E FOR 148.04 FEET;  
THENCE N68°11'55"W FOR 54.63 FEET;  
THENCE N39°14'15"W FOR 113.13 FEET;  
TO A POINT OF CURVATURE OF A CURVE CONCAVE TO THE NORTHEAST, HAVING A RADIUS OF 130.00 FEET;  
THENCE NORTHWESTERLY, ALONG SAID CURVE TO THE RIGHT, THROUGH A CENTRAL ANGLE OF 9°30'23" FOR 21.57 FEET TO THE EAST BOUNDARY OF SAID LOT 37;

THENCE ALONG SAID EAST BOUNDARY, S04°06'13"W FOR 0.69 FEET TO THE POINT OF BEGINNING.  
CONTAINING 0.780 ACRES, MORE OR LESS.

**LEGAL DESCRIPTION - GC-D**  
A PARCEL OF LAND IN SECTION 28, TOWNSHIP 44 SOUTH, RANGE 42 EAST, BEING A PORTION OF TRACTS 58 THROUGH 64, BLOCK 29, OF PALM BEACH FARMS CO. PLAT NO.3, RECORDED IN PLAT BOOK 2, PAGE 45 OF THE PUBLIC RECORDS OF PALM BEACH COUNTY, FLORIDA, MORE PARTICULARLY DESCRIBED AS FOLLOWS:

BEGIN AT THE SOUTHEAST CORNER OF THE PLAT OF LUCERNE LAKES HOMES, VILLAGE I, 6TH ADDITION, RECORDED IN PLAT BOOK 35, PAGE 76 OF SAID PUBLIC RECORDS;

THENCE ALONG THE BOUNDARY OF SAID PLAT FOR THE FOLLOWING COURSES:  
THENCE S88°42'00"W FOR 282.08 FEET;  
THENCE S87°34'45"W FOR 240.13 FEET;  
THENCE N88°39'37"W FOR 295.92 FEET;  
THENCE S81°56'16"W FOR 255.66 FEET;  
THENCE S88°38'28"W FOR 232.02 FEET;  
THENCE N00°51'20"W FOR 132.51 FEET TO THE SOUTHERLY RIGHT-OF-WAY OF LUCERNE LAKES BOULEVARD AS SHOWN ON PLAT NO.2, LUCERNE LAKES (PUD), RECORDED IN PLAT BOOK 32, PAGE 191 OF SAID PUBLIC RECORDS, BEING A NON-TANGENT CURVE, CONCAVE TO THE NORTH, HAVING A RADIUS OF 570.00 FEET, WHERE THE RADIAL LINE BEARS N00°51'20"W;

THENCE WESTERLY, ALONG SAID RIGHT-OF-WAY AND CURVE TO THE RIGHT, THROUGH A CENTRAL ANGLE OF 26°15'19" FOR 261.20 FEET TO A POINT OF REVERSE CURVATURE WITH A CURVE CONCAVE TO THE SOUTHEAST, HAVING A RADIUS OF 70.00 FEET, AS SHOWN ON SUNRISE OF PALM BEACH PLAT NO.1, RECORDED IN PLAT BOOK 39, PAGE 88 OF SAID PUBLIC RECORDS;  
THENCE SOUTHWESTERLY, ALONG SAID RIGHT-OF-WAY AND CURVE TO THE LEFT, THROUGH A CENTRAL ANGLE OF 115°23'59" FOR 140.99 FEET TO A POINT OF TANGENCY;  
THENCE CONTINUE ALONG SAID RIGHT-OF-WAY, S00°00'00"W FOR 220.07 FEET TO THE SOUTH LINE OF SAID TRACTS 58 AND 59, BLOCK 29;  
THENCE ALONG SAID SOUTH LINE, N89°59'20"E FOR 22.29 FEET TO THE BOUNDARY OF A PARCEL OF LAND DESCRIBED IN OFFICIAL RECORD BOOK 9979, PAGE 417 OF SAID PUBLIC RECORDS;

THENCE ALONG THE BOUNDARY OF SAID PARCEL FOR THE FOLLOWING COURSES:  
THENCE S01°30'52"W FOR 13.13 FEET;  
THENCE S88°33'50"E FOR 147.83 FEET;  
THENCE N01°26'10"E FOR 16.87 FEET TO THE SOUTH LINE OF SAID TRACTS 59 THROUGH 64, BLOCK 29;

THENCE ALONG SAID SOUTH LINE, N89°59'20"E FOR 149.72 FEET TO THE WESTERLY RIGHT-OF-WAY OF SAID LUCERNE LAKES BOULEVARD AS SHOWN ON PLAT NO.2, LUCERNE LAKES (PUD), RECORDED IN PLAT BOOK 32, PAGE 191 OF SAID PUBLIC RECORDS;  
THENCE ALONG SAID RIGHT-OF-WAY, N00°00'00"E FOR 95.47 FEET TO THE POINT OF CURVATURE OF A CURVE CONCAVE TO THE WEST, HAVING A RADIUS OF 325.00 FEET;  
THENCE NORTHERLY, CONTINUING ALONG SAID RIGHT-OF-WAY, ALONG SAID CURVE TO THE LEFT, THROUGH A CENTRAL ANGLE OF 9°01'07" FOR 51.16 FEET TO THE POINT OF BEGINNING.

CONTAINING 5.930 ACRES, MORE OR LESS.

**LEGAL DESCRIPTION - GC-E**  
A PARCEL OF LAND IN SECTIONS 28 AND 33, TOWNSHIP 44 SOUTH, RANGE 42 EAST, BEING A PORTION OF TRACTS 65 THROUGH 71, 90 THROUGH 95, 98 THROUGH 103, AND 122 THROUGH 127, BLOCK 29, OF PALM BEACH FARMS CO. PLAT NO.3, RECORDED IN PLAT BOOK 2, PAGE 45, OF THE PUBLIC RECORDS OF PALM BEACH COUNTY, FLORIDA, MORE PARTICULARLY DESCRIBED AS FOLLOWS:

BEGIN AT THE NORTHEAST CORNER OF TRACT 'C' OF SUNRISE OF PALM BEACH PLAT No.1, RECORDED IN PLAT BOOK 39, PAGE 88 OF SAID PUBLIC RECORDS;

THENCE ALONG THE BOUNDARY OF SAID PLAT FOR THE FOLLOWING COURSES:

THENCE S38°40'10"W FOR 117.74 FEET;  
THENCE S19°03'18"W FOR 382.89 FEET;  
THENCE S27°53'15"W FOR 316.98 FEET;  
THENCE S05°52'52"W FOR 507.63 FEET TO THE NORTH RIGHT-OF-WAY OF TAHITI LANE (TRACT 'B') AS SHOWN ON SUNRISE OF PALM BEACH PLAT No.2, RECORDED IN PLAT BOOK 43, PAGE 51 OF SAID PUBLIC RECORDS;

THENCE ALONG SAID RIGHT-OF-WAY, S45°47'39"E FOR 242.00 FEET TO THE BOUNDARY OF TRACT 'C' OF SAID SUNRISE OF PALM BEACH PLAT No.2;

THENCE ALONG THE BOUNDARY OF SAID TRACT 'C' FOR THE FOLLOWING COURSES:  
THENCE N78°40'16"E FOR 139.83 FEET;  
THENCE N01°13'31"W FOR 532.53 FEET;  
THENCE N45°15'41"E FOR 42.30 FEET;  
THENCE S46°17'54"E FOR 503.26 FEET;  
THENCE S87°07'03"E FOR 715.91 FEET;  
THENCE S24°30'27"E FOR 149.47 FEET;  
THENCE S02°14'45"W FOR 51.04 FEET;  
THENCE S43°40'59"W FOR 123.07 FEET;  
THENCE S09°21'37"E FOR 276.68 FEET;  
THENCE S33°48'40"W FOR 131.19 FEET;  
THENCE S82°43'30"W FOR 284.29 FEET;  
THENCE N85°01'42"W FOR 370.74 FEET;  
THENCE S51°35'46"W FOR 41.70 FEET;  
THENCE S78°23'23"W FOR 207.71 FEET;  
THENCE S74°32'00"W FOR 356.10 FEET;  
THENCE N06°07'35"W FOR 638.38 FEET TO THE SOUTHERLY RIGHT-OF-WAY OF SAID TAHITI LANE (TRACT 'B');

THENCE ALONG SAID RIGHT-OF-WAY, N45°47'39"W FOR 88.00 FEET TO THE EASTERLY BOUNDARY OF TRACT 'D' OF SAID SUNRISE OF PALM BEACH PLAT No.2;

THENCE ALONG SAID BOUNDARY OF TRACT 'D' FOR THE FOLLOWING COURSES:

THENCE S74°41'03"W FOR 47.17 FEET;  
THENCE S01°11'43"E FOR 407.00 FEET;  
THENCE S07°48'06"E FOR 415.60 FEET TO THE BOUNDARY OF THE PLAT OF LUCERNE POINTE PHASE III-3-C, RECORDED IN PLAT BOOK 62, PAGE 118 OF SAID PUBLIC RECORDS;

THENCE ALONG THE BOUNDARY OF SAID PLAT FOR THE FOLLOWING COURSES:  
THENCE N82°48'19"E FOR 565.84 FEET;  
THENCE N85°01'19"E FOR 403.23 FEET;  
THENCE S88°17'50"E FOR 481.45 FEET TO THE BOUNDARY OF THE PLAT OF LUCERNE LAKES GOLF COLONY II, RECORDED IN PLAT BOOK 52, PAGE 4 OF SAID PUBLIC RECORDS;

THENCE ALONG THE BOUNDARY OF SAID PLAT FOR THE FOLLOWING COURSES:  
THENCE S88°17'50"E FOR 150.67 FEET;  
THENCE N02°41'04"W FOR 476.31 FEET;  
THENCE S89°13'31"E FOR 56.20 FEET;  
THENCE N06°20'23"W FOR 572.73 FEET TO THE BOUNDARY OF THE PLAT OF LUCERNE LAKES GOLF COLONY, RECORDED IN PLAT BOOK 44, PAGE 158 OF SAID PUBLIC RECORDS;

THENCE ALONG THE BOUNDARY OF SAID PLAT FOR THE FOLLOWING COURSES:  
THENCE N06°20'23"W FOR 10.00 FEET;  
THENCE S83°51'12"W FOR 291.07 FEET;  
THENCE N89°54'39"W FOR 269.13 FEET;  
THENCE N78°02'21"W FOR 296.89 FEET;  
THENCE N48°26'20"W FOR 207.59 FEET;  
THENCE N50°01'49"E FOR 82.77 FEET;  
THENCE N07°10'25"W FOR 401.87 FEET;  
THENCE S88°35'57"E FOR 1196.60 FEET;  
THENCE N00°12'58"W FOR 416.34 FEET TO THE SOUTH RIGHT-OF-WAY OF LAKE WORTH DRAINAGE DISTRICT CANAL L-13 AS SHOWN ON SAID PLAT;

THENCE ALONG SAID CANAL RIGHT-OF-WAY, S89°59'20"W FOR 1383.22 FEET TO THE POINT OF BEGINNING.  
CONTAINING 37.840 ACRES, MORE OR LESS.

**KESHAVARZ & ASSOCIATES, INC.**  
THIS INSTRUMENT WAS PREPARED BY  
CHARLES H. ANDERSON, IN THE OFFICE OF  
KESHAVARZ & ASSOCIATES, INC.  
1280 N. CONGRESS AVENUE SUITE 206  
WEST PALM BEACH, FLORIDA 33409  
TELEPHONE: (561)689-8600 FAX: (561)689-7476  
LICENSED BUSINESS No.LB4897

Subdivision: Lucerne Lakes  
Block: 29  
Flood Zone: B  
Quadrant: 4B  
SEC: 28  
TAZ: 316  
PUD NAME: Lucerne Lakes